

# Soft polyurethane wheels

## Aluminium centre body

### COVERING

Soft mould-on polyurethane, hardness 75 Shore A.

### WHEEL CENTRE BODY

Pressure die-cast aluminium.

### ROLLING ACTION

Hub with ball bearings. Ideal solution for heavy loads and continuous moving.

### APPLICATIONS

Excellent smoothness and elasticity features, high wear and tearing resistance.

For selection parameters see Technical data on page -.

RE.F2 wheels are supplied also with bracket:

- RE.F2-N (see page -): wheels with steel sheet bracket to be used for light loads.
- RE.F2-H (see page -): wheels with steel sheet bracket to be used for medium-heavy loads.
- RE.F2-WH (see page -): wheels with electro-welded steel bracket to be used for heavy loads.

### ENVIRONMENTAL CONDITIONS

Suitable for use in environments with the presence of atmospheric agents, alcohols and glycols; use in environments with the presence of organic and mineral acids, basic solutions and saturated vapour is not recommended.

### ROLLING RESISTANCE - FORCE / LOAD APPLIED

For each load and diameter, the table indicates the force (in N) needed to push or pull a single wheel at a constant speed of 4 km/h on smooth ground.

For manual handling of a 4-wheel trolley, it is recommended to choose diameters with values below 50 N; for frequent handling, choose values below 30 N.

### MECHANICAL MOVING WITH TOWING DEVICES

For mechanical towing, please see the Technical datato determine the capacity variation.

### TEMPERATURE

If operating temperatures in an application differ from the standard range of values, please see the technical specifications to determine the capacity variation.



Traction force or thrust for wheel movement [N]							
		Load [N]					
		1500	2500	3500	4500	5500	7000
D [mm]	100	20	35	-	-	-	-
	125x40	<10	15	38	-	-	-
	125x50	<10	15	38	-	-	-
	160	<10	10	20	30	35	-
	200	<10	<10	10	20	30	40

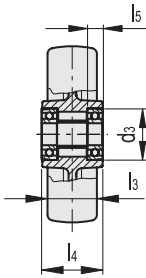
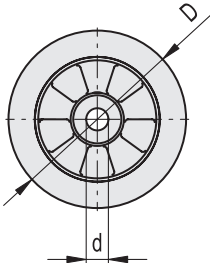

Code	Description	D	d	d3	l3	l4	l5	Static load# [N]	Rolling resistance# [N]	Dynamic carrying capacity# [N]	
452411	RE.F2-100-RSL	100	15	32	40	40	9	4000	3000	3000	450
452416	RE.F2-125x40-RSL	125	20	47	40	40	14	5000	3500	3500	790
452412	RE.F2-125x50-RSL	125	20	47	40	50	14	5000	3500	3500	750
452413	RE.F2-160-RSL	160	20	47	50	58	14.5	8000	5500	5500	1200
452414	RE.F2-200-RSL	200	20	47	50	58	14.5	10000	7000	7000	1740

# For rolling resistance and dynamic carrying capacity see Technical data (on page -).