

# Transfer unit and angular gears

## Application example

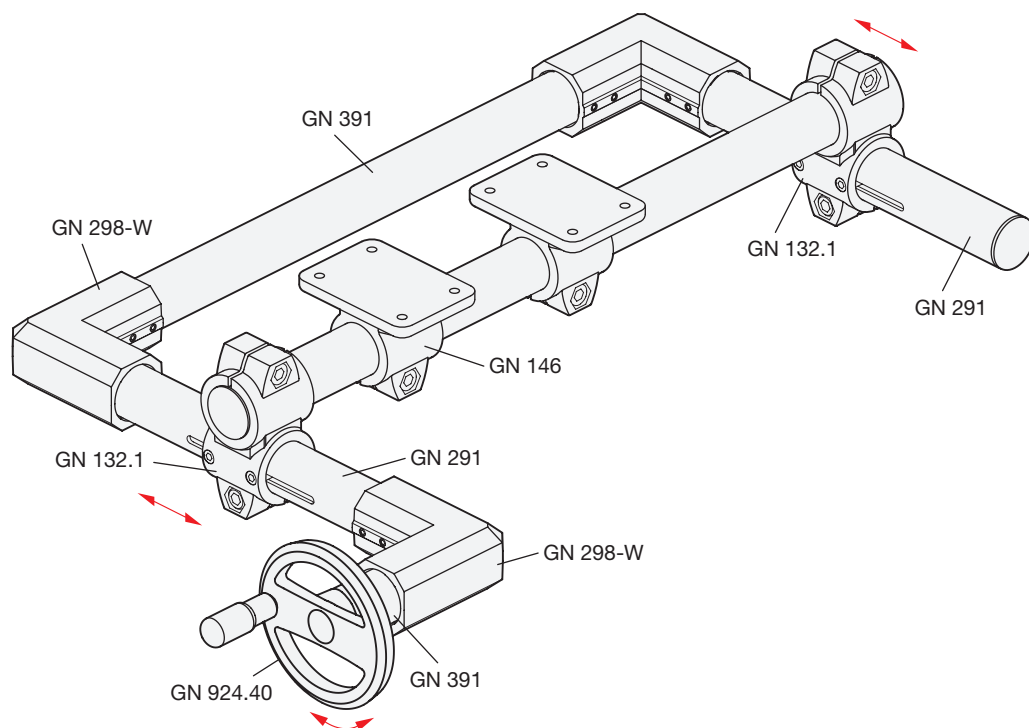

Two parallel sliding linear actuators GN 291 (see page 1912) are connected with a transfer unit GN 391 (see page 1940).

The angular housings GN 298-W (see page 1942) including the bevel gear wheels GN 297 (see page 1941) and another transfer unit GN 391 connect the handwheel with the system. The handwheel is placed in a rectangular position to the moving axes.

# Transfer unit and angular gears

## Application example

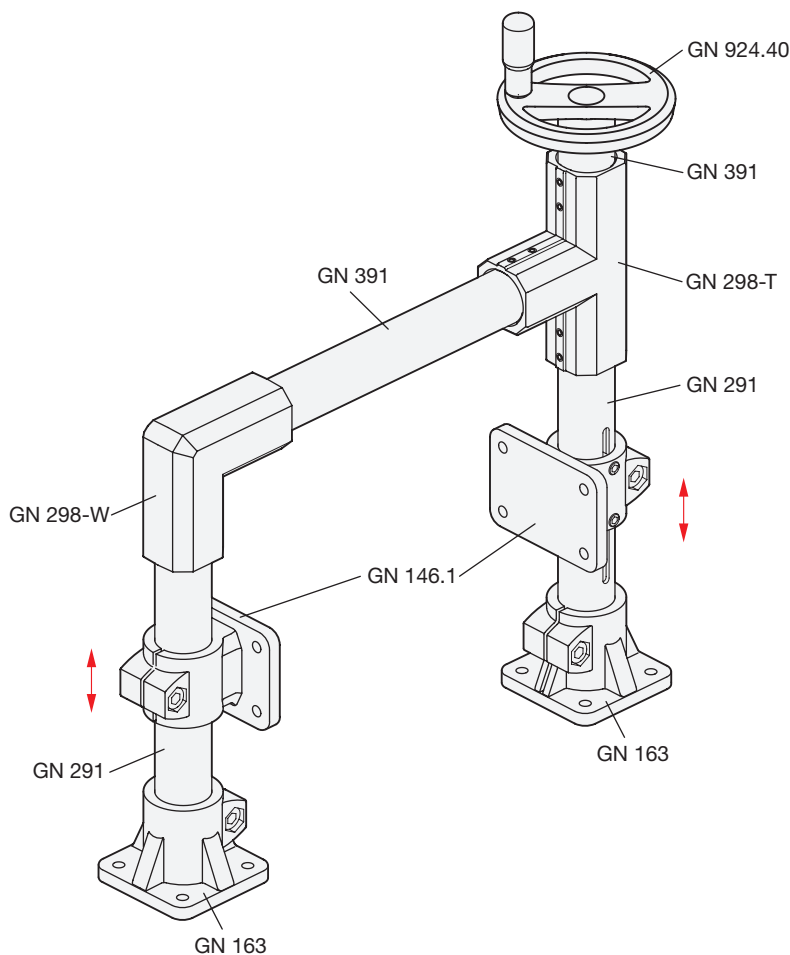

Two flanged linear actuator connectors GN 146.1 (see page 1923) are moved parallel. For this two linear actuators GN 291 (see page 1912) are connected with a transfer unit GN 391 (see page 1940).

The T- and angular gear GN 298-T/-W (see page 1942) including the bevel gear wheels GN 297 (see page 1941) and another transfer unit GN 391 (see page 1940) connect the handwheel with the system. The handwheel is placed in a parallel position to the moving axes.

