

Slam latches with compact design

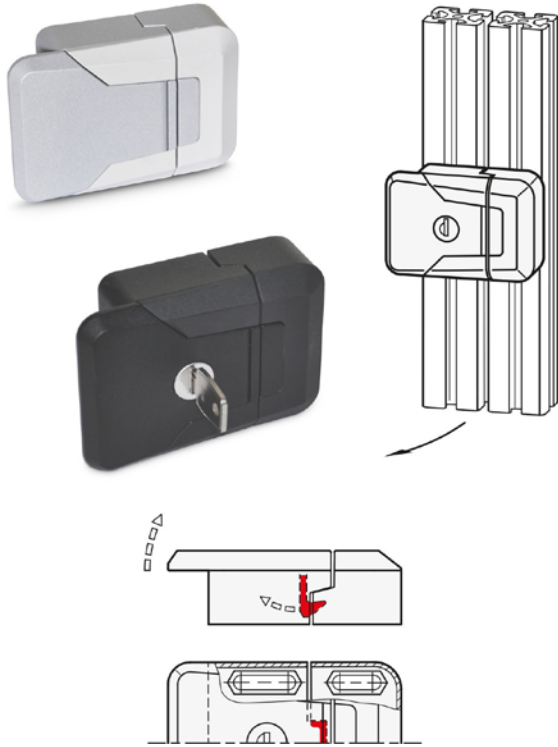

Elegantly designed and extremely functional: The new slam latches GN 936 from Elesa+Ganter, secure against manipulation and available with or without integrated lock.

They are compact, universally compatible and secure against manipulation: The slam latches GN 936 from Elesa+Ganter serve as surface-mounted latches, primarily in systems engineering. By automatically latching doors, flaps or other access points to work rooms, automation zones and machine enclosures when the latch snaps into place, slam latches are always the first choice when quick and easy solutions are required.

The new slam latches are mounted on the surface and are compatible with a very wide range of profile systems as chosen by the customer. Naturally, they can also be mounted to smooth surfaces. In the latter case, it is also possible to affix the part from the rear. Socket head cap screws, hexagon head screws and hexagon nuts, all in thread size M6, may be used for mounting. Thanks to the slot design, it is easy to adjust for different gap dimensions between the frame and the door.

The housing as well as the lock mechanisms are made of robust die-cast zinc and are available with black or silver coating. The latches and covers are produced of plastic in matching colors featuring a subtle texture. A wide bevel running around the edge gives the slam latch an elegant and lightweight appearance, as does the accentuated shape of the release grip. The compact standard part is available in three versions: a non-lockable variant entirely without lock and two versions, one with universal key and one with a unique key.

In addition to the robust design, protection against manipulation was a high priority during development: The catch and the latch engage with an offset and with relative positioning that prevents unauthorized opening right from the start. The front or rear mounting options are also designed in consideration of security aspects. In the closed state, the slam latch cannot be removed. The mounting points remain hidden under plastic covers that can only be removed while the slam latch is open. Only then it is possible to access the screws.

You can find more information online at www.elesa-ganter.com

Contact:

Axel Weber | +49 7723 65 07 22 6 | axel.weber@ganter-griff.de

OTTO GANTER GmbH & Co. KG

Triberger Straße 3 / 78120 Furtwangen | Germany

+49 7723 65 07 0 | info@ganter-griff.com | ganter-griff.com

elesa-ganter.com



DESIGNED
FOR ENGINEERING