

New Hinge Generation for Precise Movements

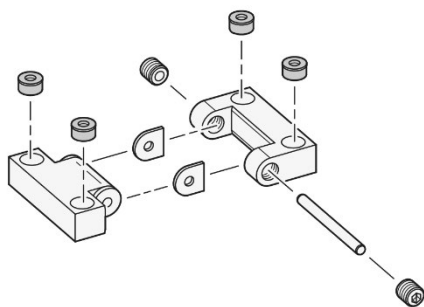

The new precision hinges from Elesa+Ganter – available in many different versions – are wear resistant while delivering extreme precision and exhibiting zero backlash.

Certain applications, such as in jig construction, automation systems or testing systems, require moving elements supported by extremely precise bearings. In concrete terms, this means a combination of maximum repeatability, zero backlash, long service life and adjustability. These are exactly the properties of the new precision hinges GN 7580, which might be more accurately referred to as joints. Of course, the Elesa+Ganter portfolio already contains many different hinge versions, but these new products are generally suited to a unique range of applications. Facing increased demand for extremely precise pivot bearings, Elesa+Ganter decided to design optimal solutions to fill this gap.

The GN 7580 family consists of three size variants, each with four inner and outer leaf types. The leaves differ in turn by the type of mounting, which can be tangential or radial and make use of countersunk cylindrical bores or integrated threaded bushings of stainless steel. Plus, Elesa+Ganter put thought into ensuring simple and positionally accurate mounting: The fitting bores ensure exact positioning of the hinges during installation.

The four leaf types are designed to be mutually compatible and can be used together as needed in any combination. As usual with Elesa+Ganter, they can even be ordered separately via specific article numbers. This ensures that the precision hinges cover a very wide range of applications. In general, Elesa+Ganter supplies the precision hinges pre-assembled according to the customerspecific configuration.

To ensure lasting precision, the hinges can be re-adjusted at any time. The axial adjusting screws allow the hinge to be adjusted for smooth or stiff motion. The materials have been chosen in line with the level of precision. The hinges are made of black anodized and high-strength alloyed aluminum, while the bearing bushings are made of bronze. Elesa+Ganter uses stainless steel for the hardened hinge axis as well as the thrust washers and adjusting screws. An additional polyamide coating on the adjusting screws provides for thread locking.

More information on Elesa+Ganter standard parts can be found in the internet at: [elesa-ganter.com](https://www.elesa-ganter.com)

Contact:

Axel Weber | +49 7723 65 07 22 6 | axel.weber@ganternorm.com

OTTO GANTER GmbH & Co. KG

Triberger Straße 3 | 78120 Furtwangen | Germany

+49 7723 65 07 0 | info@ganternorm.com | [ganternorm.com](https://www.ganternorm.com)

[elesa-ganter.com](https://www.elesa-ganter.com)



DESIGNED
FOR ENGINEERING