

Orientation of keyways

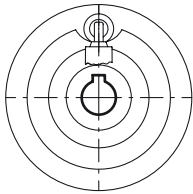

Solid handwheels

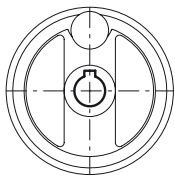

Spoked handwheels

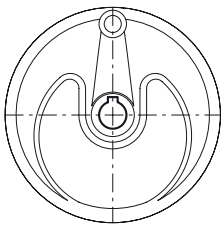

Monospoke handwheels

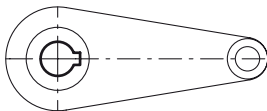

Crank handles

DIN 6885/1 KEYWAYS

d	b P9/JS9 Hub keyway	b P9/N9 Shaft-keyway	h	t2	t4
from 6 to 8	2	2	2	1 +0.1	1.2 +0.1
over 8 to 10	3	3	3	1.4 +0.1	1.8 +0.1
over 10 to 12	4	4	4	1.8 +0.1	2.5 +0.1
over 12 to 17	5	5	5	2.3 +0.1	3 +0.1
over 17 to 22	6	6	6	2.8 +0.1	3.5 +0.1
over 22 to 30	8	8	7	3.3 +0.2	4 +0.2
over 30 to 38	10	10	8	3.3 +0.2	5 +0.2
over 38 to 44	12	12	8	3.3 +0.2	5 +0.2
over 44 to 50	14	14	9	3.8 +0.2	5.5 +0.2

Width of keyway:

P9 tight fit (standard design)

JS or N9 loose fit (requires agreement in writing)

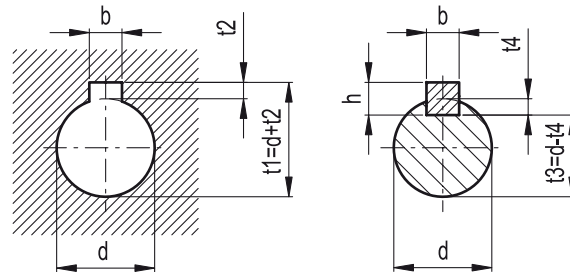

DIN 6885/2 KEYWAYS

d	b P9/JS9 Hub keyway	b P9/N9 Shaft-keyway	h	t2	t4
from 10 to 12	4	4	4	1.1 +0.1	3 +0.1
over 12 to 17	5	5	5	1.3 +0.1	3.8 +0.1
over 17 to 22	6	6	6	1.7 +0.1	4.4 +0.1
over 22 to 30	8	8	7	1.7 +0.2	5.4 +0.2
over 30 to 38	10	10	8	2.1 +0.2	6 +0.2
over 38 to 44	12	12	8	2.1 +0.2	6 +0.2
over 44 to 50	14	14	9	2.6 +0.2	6.5 +0.2

Width of keyway:

P9 tight fit (standard design)

JS or N9 loose fit (requires agreement in writing)

