

ERZ. Adjustable Handles with new retaining screw with six-lobed socket to fit Torx® tool:

Current retaining screw with hexagon socket

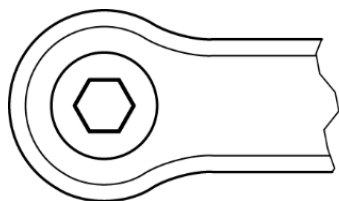

New retaining screw with six-lobed socket

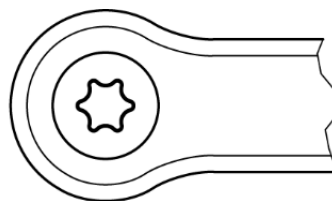

Dear Elesa+Ganter Partners,
We inform you that [ERZ. adjustable handles](#) will be available in the version with hexagon socket while stocks last. Then they will be replaced by adjustable handles having a six-lobed socket to fit Torx® tool (registered trademark of TEXTRON INC.).



ERZ. Adjustable Handle

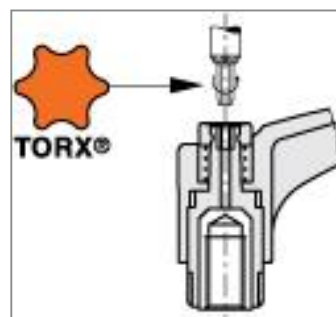

See also the ERZ. updated datasheet on www.elesa-ganter.com.



Elesa S.p.A.
Via Pompei, 29 – 20900 Monza
Italy
Tel. +39 039 28 111
fax +39 039 83 63 51

www.elesa-ganter.com
info@elesa-ganter.com

Thank you for your attention.

We remain at your disposal for any further information you may need.