

12. TECHNICAL TABLES



A
16

Technical data

CONVERSION TABLE

Parameter	IS unit	To convert IS unit into	multiply by
Force	N	kg	0.1
Torque	Nm	kg · m	0.1
Work	J	kg · m	0.1

To convert	into	multiply by
mm	inches	0.039
N	lbf	0.224
Nm	lb · ft	0.737
J	ft · lb	0.737
g	lb	0.002
°C	°F	$(°C \cdot 9/5) + 32$

DIN 79 SQUARE HOLES AND SHAFTS

s H11/h11	d max.	e1 max.	e1 min.	e2 min.
4	4.2	5	4.8	5.3
5	5.3	6.5	6	6.6
5.5	5.8	7	6.6	7.2
6	6.3	8	7.2	8.1
7	7.3	9	8.4	9.1
8	8.4	10	9.6	10.1
9	9.5	12	10.8	12.1
10	10.5	13	12	13.1
11	11.6	14	13.2	14.1
12	12.6	16	14.4	16.1
13	13.7	17	15.6	17.1
14	14.7	18	16.8	18.1
16	16.8	21	19.2	21.2
17	17.9	22	20.4	22.2
19	20	25	22.8	25.2
22	23.1	28	26.4	28.2
24	25.3	32	28.8	32.2
27	28.4	36	32.4	36.2
30	31.7	40	36	40.2
32	33.7	42	38.4	42.2
36	38	48	43.3	48.2
41	43.2	54	49.3	54.2
46	48.5	60	55.2	60.2
50	52.7	65	60	65.2
55	57.9	72	66	72.2

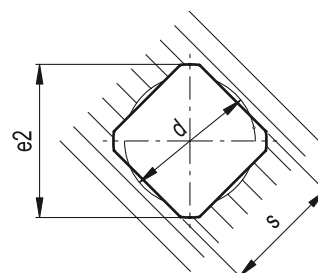
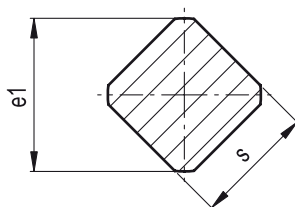

elesa-GANTER

ELESA and GANTER models all rights reserved in accordance with the law. Always mention the source when reproducing our drawings.